

P.U.D.

PLAN URBANISTIC DE DETALIU

ELABORARE P.U.D.
"HALA PRODUCTIE SI ANEXE"

PLAN
MOBILARE URBANISTICA

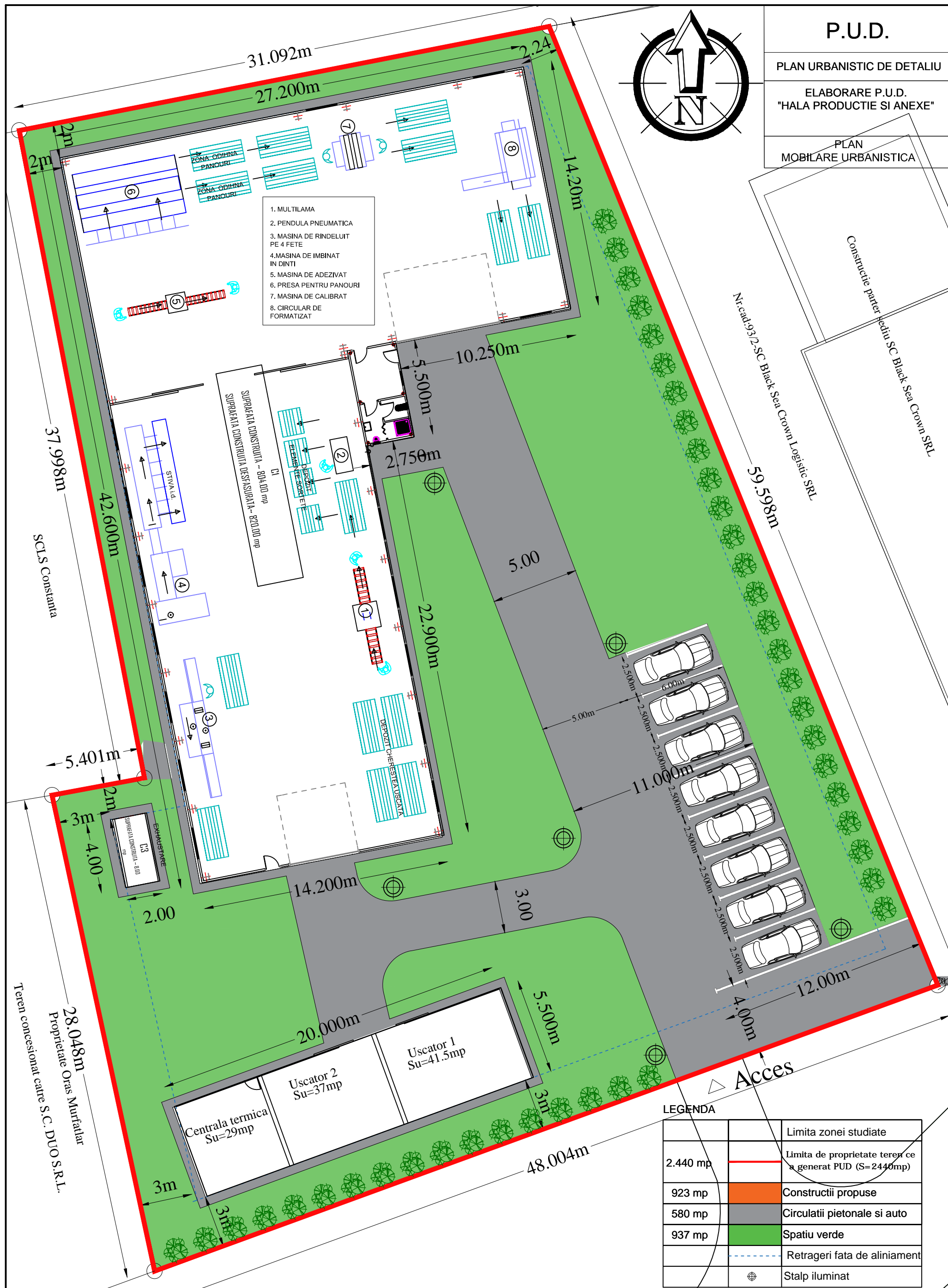
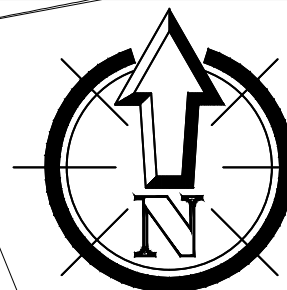

1. MULTILAMA
2. PENDULA PNEUMATICA
3. MASINA DE RINDEUIT PE 4 FETE
4. MASINA DE IMBINAT IN DINTI
5. MASINA DE ADEZIVAT
6. PRESA PENTRU PANOURI
7. MASINA DE CALIBRAT
8. CIRCULAR DE FORMATIZAT

LEGENDA

		Limita zonei studiate
2.440 mp		Limita de proprietate teren ce a generat PUD (S=2440mp)
923 mp		Constructii propuse
580 mp		Circulatii pietonale si auto
937 mp		Spatiu verde
		Retrageri fata de aliniament
		Stalp iluminat

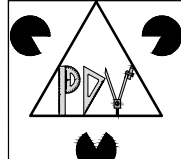

SC ProDesign View SRL
C.U.I.:28194012 ; Nr.O.R.C.:J13 /635/16.03.2011
IBAN: RO82RNCB0296120842020001
Tel : 0761.835335 ; mail : avrejoiu@gmail.com

SEF PROIECT
Arh. Crudu Gheorghe
PROIECTAT
Arh. Crudu Gheorghe

DESENAT
ing. Vrejoiu Adrian
0761835335

P.U.D. "HALA PRODUCTIE SI ANEXE"			
BENEFICIAR	BLACK SEA CROWN LOGISTIC S.R.L.		
ADRESA OBIECTIV	Oras Murfatlar, strada Minerului, nr. 24A		
NR. PROIECT	FAZA	SCARA	PLANSA
58/2017	PUD	1:200	
PLAN MOBILARE URBANISTICA			DATA
			Septembrie 2017
			P 06

SCLS Constanta
37.998m
42.600m
5.401m
3m
4.00m
2.00
28.048m
Proprietate Oras Murfatlar
Teren concesionat catre S.C. DUO S.R.L.

Nr.cad:932-SC Black Sea Crown Logistic SRL
59.598m
Construcție parter sediu SC Black Sea Crown SRL

Acces

Uscator 1
Su=41.5mp
Uscator 2
Su=37mp
Centrala termica
Su=29mp

SUPRAFATA CONSTRUITA - 804,00 mp
SUPRAFATA CONSTRUITA DESFASURATA - 820,00 mp

EXHAUSTARE
C3
SUPRAFATA CONSTRUITA - 8,00 mp

DEPOZIT CHESTIEA USCATIA

STIVALD

31.092m
27.200m
2.24m
14.200m
10.250m
5.500m
2.750m
5.00
22.900m
11.000m
14.200m
3.00
20.000m
5.500m
3m
48.004m